

SF17
S4/04
SECTION
1:20

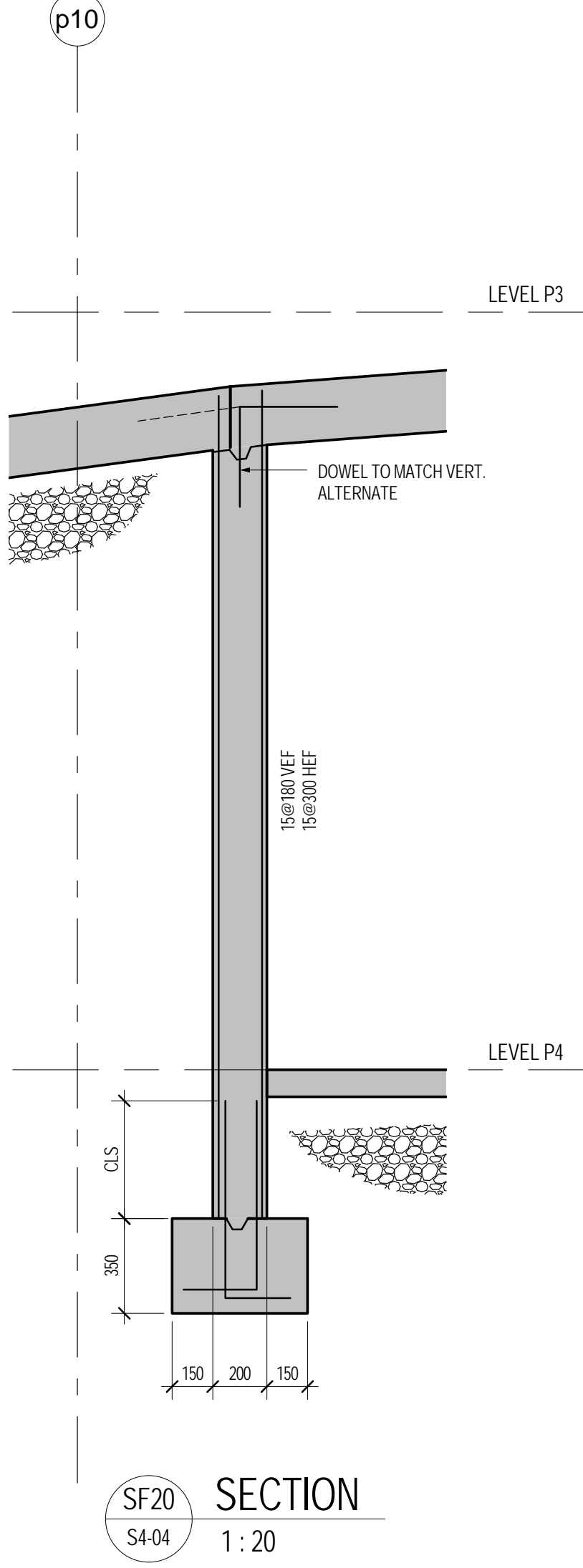

SF18
S4/04
SECTION
1:20

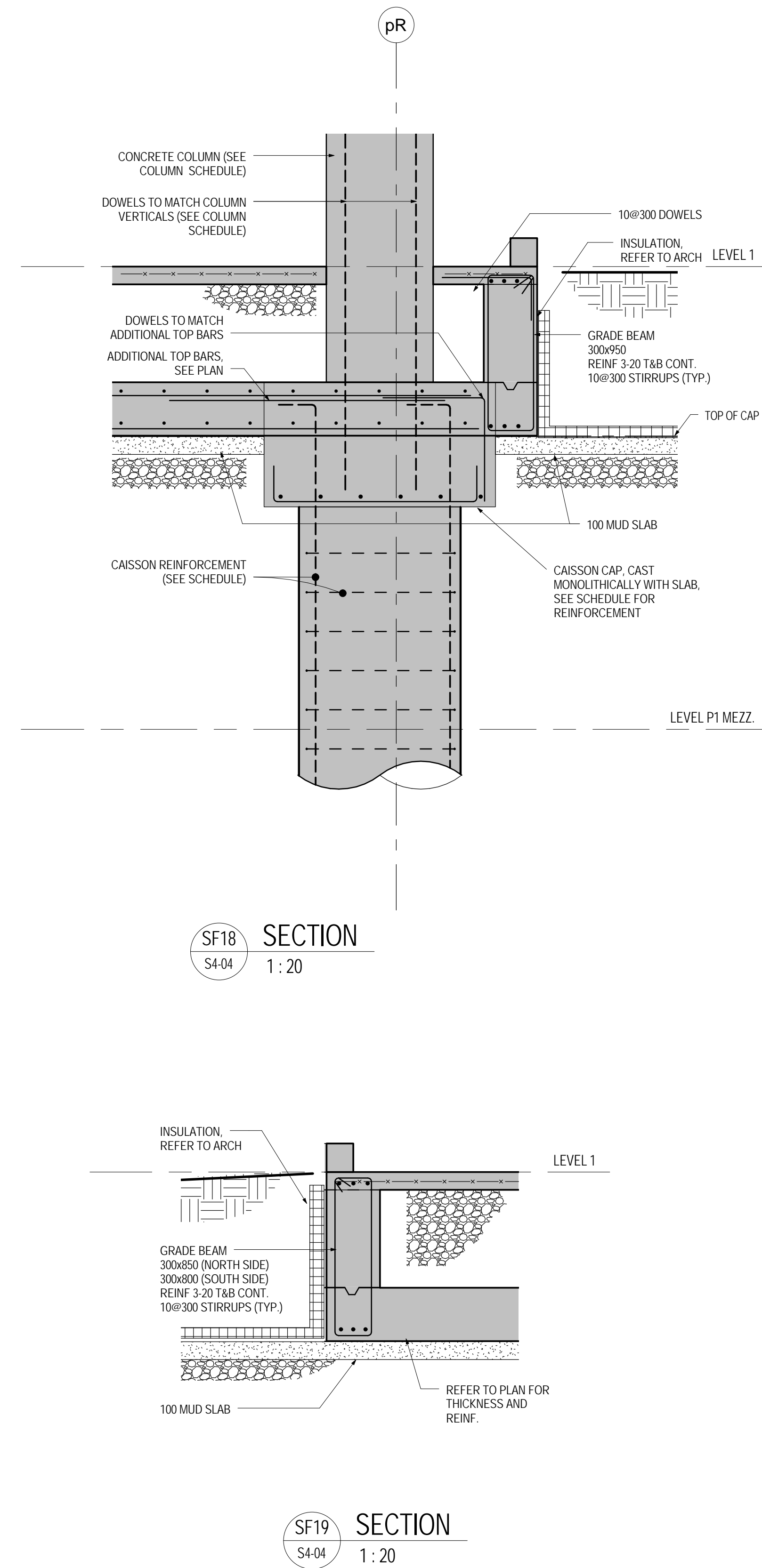

SF19
S4/04
SECTION
1:20

1. REFER TO TYPICAL DETAILS T-C56A AND T-C56B FOR T.L.S. TENSION LAP SPICES AND C.L.S. COMPRESSION LAP SPICES LENGTHS.
2. OVERALL LENGTH OF REINFORCEMENT SHOULD ACCOUNT FOR VARIATIONS IN TOP OF FOOTING ELEVATION WHILE STILL MEETING THE MINIMUM LAP SPICES INDICATED. VARIATIONS IN FOOTING ELEVATION DURING CONSTRUCTION WILL REQUIRE MODIFICATION TO REINFORCEMENT TO ACCOMMODATE ACCORDINGLY.

4	BUILDING PERMIT	SEPT 21, 2015
3	BUILDING PERMIT	JULY 22, 2015
2	BUILDING PERMIT SUBMISSION	JUNE 12, 2015
1	ISSUED FOR REVIEW	MAY 01, 2015

AQUAVISTA
AT BAYSIDE TORONTO

Drawing Title
FOUNDATION SECTIONS

Project
Hines TRIDEL
AQUAVISTA
Block 3 - R3 & R4
Merchant's Wharf
Toronto, ON
Scale

As indicated
DC
IA/BBS
20140031
SEPT 21, 2015
Drawing No.

Drawn by
Checked by
Project No.
Date
Drawing No.

S4-04